



Project update

Work is well underway on the upgrade to the Great Northern Highway between Lennard Street and Haddrill Road.

The Services Authorities have relocated all water, power and telecommunications services, which should mean an end to any major service disruptions (see 'Emergency Contacts' list on the back page to find out who to contact if you do experience problems).

Bus stops have been moved to their temporary locations during the roadworks, with gravel bus bays being created to allow buses to pull off to the side of the road to collect and drop off passengers.

Two lanes have been maintained throughout this phase of the work, and this will continue to be a priority for contractor Highway Construction.

Temporary accesses have been created for properties along the Padbury Road to Haddrill Road and McDonald Street to River Road stretch of the Highway, where a temporary sealed road has been created to the East of the existing road. All land clearing has now been completed, with trees removed where necessary.

The project is currently running on schedule, and contractors Highway Construction are confident of works being completed later this year.

What's next?

During the coming weeks the new section of the road will begin to take shape, with asphaltting of the northern carriageway.

Once the asphaltting is completed in March, traffic will be transferred across to this new section of road to enable work to begin on the southbound lane.

Work will continue on this section until late May.

Streetlights will start to be installed from early April and will be operational by the end of May.

Road design

The upgrade to the Great Northern Highway is designed to create a safer road that is better suited to carrying the type and volume of traffic that uses the road.

The road is being widened, and will include an 800m long overtaking lane in both directions, turning pockets into side roads, stormwater and offroad drainage, and the construction of culverts to improve water flow around the road.

See the plan on the next page for more information about the design of the road.

Lennard Street to Haddrill Road at a glance

Funded by the Australian Federal Government Accelerated Upgrade funding package

- › Turning pockets into side roads
- › Stormwater and offroad drainage
- › Wider road
- › 800m overtaking lane in both directions
- › Culverts to improve water flow

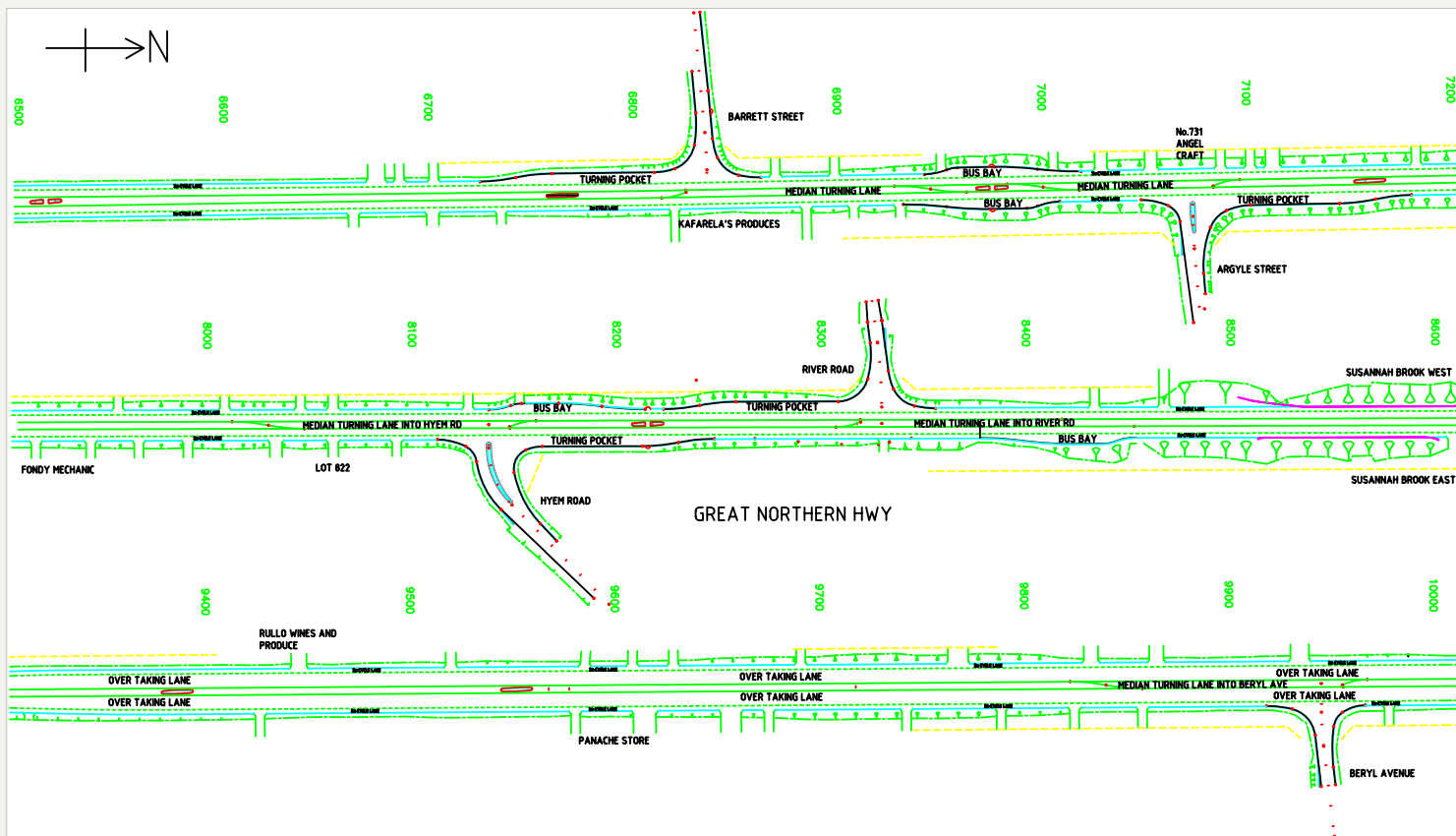

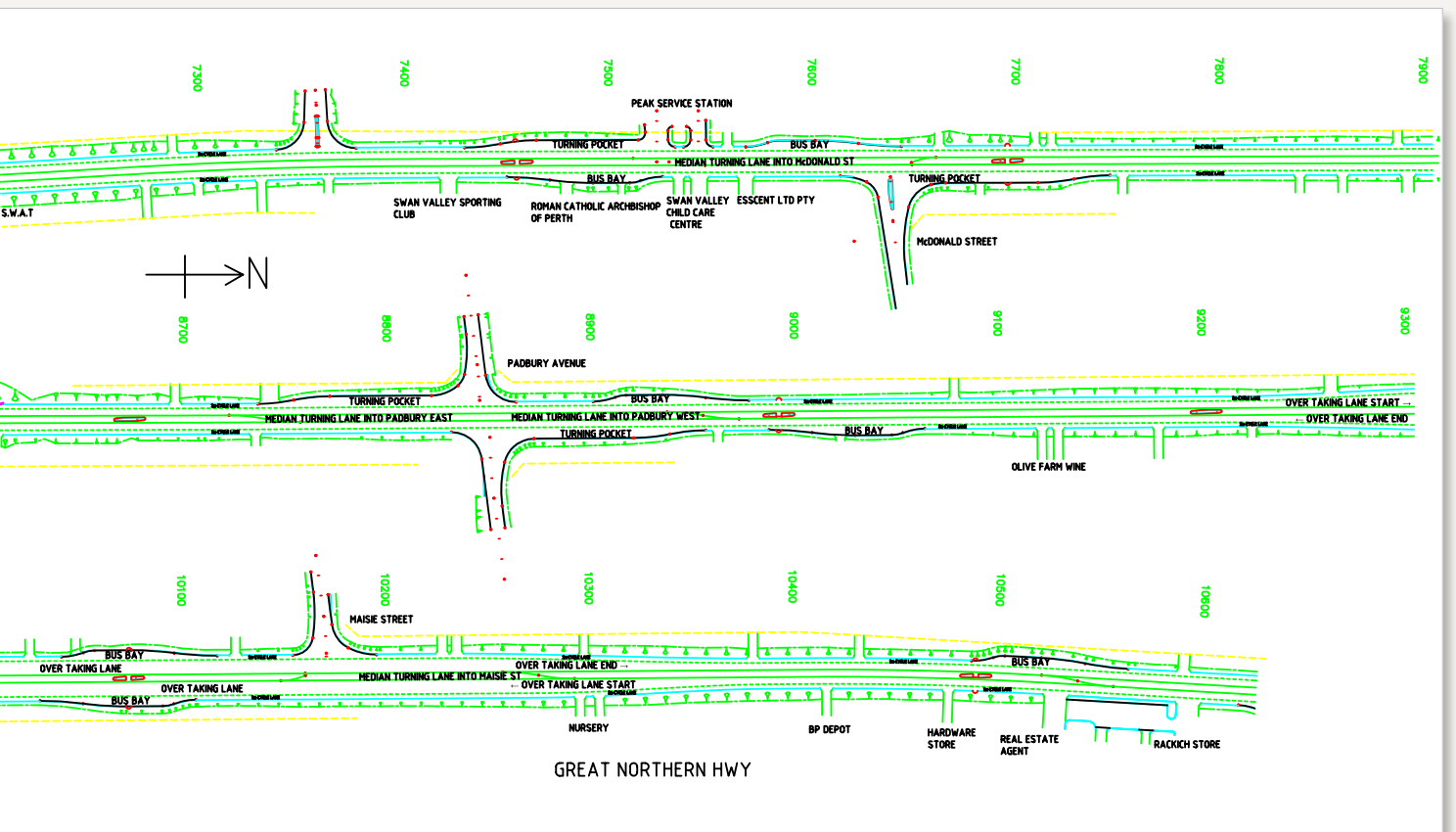

Maintaining service supply

Work on this section of the Great Northern Highway has been particularly challenging due to the age and location of underground services.

Identifying the site of older, buried services has been difficult where no records exist detailing their location. The fragility of some of these older services has also meant they are more vulnerable to damage from work taking place nearby.

There have also been a number of other contractors and service authorities working in the area.

As a result of all of these factors, there has been a greater level of service disruption for residents than anticipated.

“Minimising service disruption for residents and businesses has been a real challenge for all contractors and service providers working on this project,” Highway Construction’s John Powell said.

“We are very aware of how difficult it can be for residents when their water supply is interrupted, and we liaise with Main Roads WA and service providers to do everything we can to avoid this happening.”

Increased funding

A team effort between Main Roads WA, Highway Construction and the Federal Member for Pearce Judi Moylan has resulted in an improved funding package being secured from both the Federal and State Governments to ensure a better quality road for this section of the Great Northern Highway.

The Federal Government has agreed to new funding arrangements that will inject an additional \$5 million into the project, enabling the road to be constructed using a superior quality asphalt, rather than granular rock pavement material.

The Western Australian State Government has also contributed additional funding to provide for this higher standard of material for the highway.

“This is great news for all road users on the Great Northern Highway, and for WA taxpayers,” Highway Construction’s Paul Saunders said.

“Using a superior quality asphalt will reduce the cost of maintaining the road, delivering a long term financial benefit to the taxpayer.”



Emergency Contacts

Water service disruption Water Corporation 13 13 75 (24 hrs)

Power supply disruption Western Power 13 13 51 (24 hrs)

Road design Don Scott, Community Relations Manager,
Main Roads WA 9227 6201/0419 860 979

Construction works/ Not sure who to call? Louise Richardson, Community Relations Manager,
Highway Construction 0411 141 842